

LIV 3 VALVE MANIFOLD

SERIES 3T0

For direct transmitter
mounting with connection
out of centre line

Principle

LIV valve manifold is directly mounted on a differential pressure transmitter, having the standard 54 mm (2 1/8") distance between plus and minus connection. The manifold has 2 isolating and 1 equalizing valve.

Construction.

- The valve body is machined from a rectangular bar stock material.
- The raw material of the manifolds can be supplied according to NORSOK M 630 or to customer's specific requirements.
- The 2 inlet connections are 1/2" NPT int. (standard), or 1/4" NPT int.
- The 2 outlet connections (transmitter side) are according to EN/IEC 61518 type A (standard) or type B
- The manifold is supplied with 2 x M10 mounting holes, 30 mm apart.
- The valve spindle thread is external to stuffing box.
- The manifolds have back-seating and non-rotating valve tip
- The dust covers are coloured for application indication (isolate, equalize)
- The manifolds are designed for PED 2014/68/EU.

Technical Data

Material	AISI 316 (standard), A350LF2, 22Cr Duplex, 25Cr Duplex, 6Mo, Titanium, Monel 400, Hastelloy C, Inconel 625 and 825
Packing	PTFE, Graphite
Pressure rating	6000 psi (420 bar)
Temperature	+40 to +120 °C.
Operation	T-bar, Anti tamper
Valve tip	Hardened

Testing and Documentation

- Material certificate to EN 10204-3.1
- Certificate of compliance to NACE MR 01-75 or EN 15156
- Optional: cleaned for oxygen and hydrogen
- Pressure test certificate

Accessories

- Mounting bracket
- 7/16" x 45 mm or M10 x 45 mm bolts and gaskets for transmitter mounting
- 1/4" NPT plugs (for manifold with drain connection)

TYPE
3T000

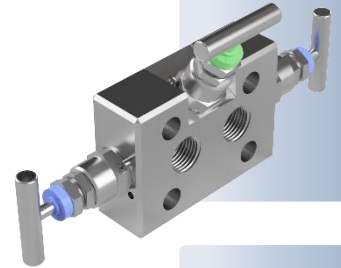

TYPE
3T001

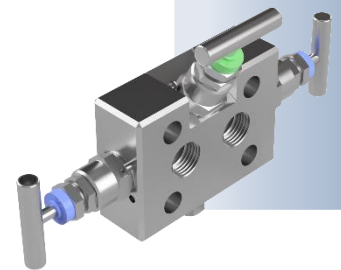

FLOW DIAGRAM

TYPE 3T000

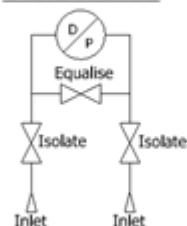

TYPE 3T001

FLOW DIAGRAM

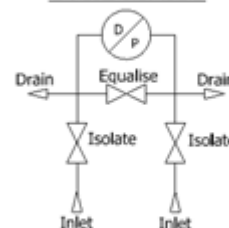

HOW TO ORDER

Choose a code for each of the configuration steps. For special orders, please reach out to our sales team.

1 VALVE TYPE		2 MANIFOLD CONNECTION INLET		3 CONNECTION TYPE		4 MANIFOLD CONNECTION OUTLET	
3T000	3 valve	1	¼"	A	NPT	A	With spigot
3T001	3 valve with drain connection	3	½"	B	BSPP (G)	B	Without spigot
				F	BSPT (R)		
5 MATERIAL							
	<i>Body material</i>		<i>Trim material</i>				
01	A350 LF2		AISI 316				
02	A479 316		AISI 316				
04	A479 22Cr duplex		22Cr. Duplex				
06	A479 25Cr duplex		25Cr. Duplex				
08	A479 6Mo 6Mo		6Mo				
10	Titanium		Titanium				
11	Monel 400		Monel 400				
12	Hastelloy C-276		Hastelloy C-276				
13	Inconel 625		Inconel 625				
14	Inconel 825		Inconel 825				
6 SEALS		7 PRESSURE RATING		8 VALVE OPERATION			
T	PTFE solid	06	6000 psi	01	3 x T-bar		
G	Graphite			02	3 x Anti tamper		
				03	3 x Anti tamper lockable		
				09	Specify combination		

Example: Type 3T001.3AA02T0601

3 valve manifold for direct transmitter mounting with drain connections, ½" NPT AISI 316, PTFE, 6000 psi, T-bar.